

# CANNERY ROW

BEING A REPLAT OF A PORTION OF BLOCK 73, SUBDIVISION OF BLOCK 73  
(PLAT BOOK 12, PAGE 62, P.R.P.B.CO.), LYING IN SECTION 16, TOWNSHIP  
46 SOUTH, RANGE 43 EAST, CITY OF DELRAY BEACH, PALM BEACH COUNTY, FLORIDA.

AUGUST 2006  
SHEET 2 OF 2

THIS INSTRUMENT WAS PREPARED BY PAUL D. ENGLE, IN THE OFFICE OF  
O'BRIEN, SUITER & O'BRIEN, INC., 2601 NORTH FEDERAL HIGHWAY, DELRAY  
BEACH, FLORIDA 33483.  
(561) 276-4501

LEGEND:

- CL = CENTERLINE
- P.R.M. = PERMANENT REFERENCE MONUMENT (4" X 4" CONCRETE MONUMENT STAMPED "PRM LB 353")
- C.A. = CENTRAL ANGLE
- C.B. = CHORD BEARING
- O.R.B. = OFFICIAL RECORD BOOK
- R.P. = RADIUS POINT
- RAD. = RADIUS
- P.R.P.B.CO. = PUBLIC RECORDS OF PALM BEACH COUNTY
- G.U.E. = GENERAL UTILITY EASEMENT

CURVE #	CENTRAL ANGLE	LENGTH	RADIUS	CHORD BEARING
C-1	24°34'33"	8.36	19.50	S77°42'44"E
C-2	90°00'00"	14.92	9.50	N45°00'00"W
C-3	90°00'00"	14.92	9.50	N45°00'00"W
C-4	27°52'33"	8.36	19.50	N77°42'44"E
C-5	90°00'00"	8.42	6.00	N45°00'00"W
C-6	90°00'00"	2.36	1.50	N45°00'00"W
C-7	90°00'00"	2.36	1.50	N45°00'00"W
C-8	90°00'00"	3.93	2.50	N45°00'00"W
C-9	90°00'00"	3.93	2.50	N45°00'00"W
C-10	90°00'00"	5.71	4.00	N45°00'00"W
C-11	90°00'00"	5.71	4.00	N45°00'00"W
C-12	24°34'33"	8.36	19.50	S77°42'44"E
C-13	24°34'33"	8.36	19.50	S77°42'44"E
C-14	24°34'33"	8.36	19.50	S77°42'44"E
C-15	90°00'00"	3.74	2.00	N45°00'00"W

LOT #	AREA	LOT #	AREA	LOT #	AREA
1	1767 SQ.FT.	35	1476 SQ.FT.	69	1731 SQ.FT.
2	1800 SQ.FT.	36	1510 SQ.FT.	70	1664 SQ.FT.
3	1800 SQ.FT.	37	1510 SQ.FT.	71	1556 SQ.FT.
4	1800 SQ.FT.	38	1510 SQ.FT.	72	1533 SQ.FT.
5	1800 SQ.FT.	39	1510 SQ.FT.	73	1738 SQ.FT.
6	1800 SQ.FT.	40	1510 SQ.FT.	74	1800 SQ.FT.
7	1800 SQ.FT.	41	1510 SQ.FT.	75	1800 SQ.FT.
8	1800 SQ.FT.	42	1784 SQ.FT.	76	1800 SQ.FT.
9	1800 SQ.FT.	43	1784 SQ.FT.	77	1800 SQ.FT.
10	1800 SQ.FT.	44	1784 SQ.FT.	78	1800 SQ.FT.
11	1800 SQ.FT.	45	1784 SQ.FT.	79	1800 SQ.FT.
12	1800 SQ.FT.	46	1784 SQ.FT.	80	1800 SQ.FT.
13	1743 SQ.FT.	47	1784 SQ.FT.	81	1800 SQ.FT.
14	1577 SQ.FT.	48	1784 SQ.FT.	82	1800 SQ.FT.
15	1367 SQ.FT.	49	1784 SQ.FT.	83	1800 SQ.FT.
16	1714 SQ.FT.	50	1532 SQ.FT.	TRACT A	200 SQ.FT.
17	1701 SQ.FT.	51	1532 SQ.FT.	TRACT B	200 SQ.FT.
18	1332 SQ.FT.	52	1532 SQ.FT.	TRACT C	200 SQ.FT.
19	1328 SQ.FT.	53	1476 SQ.FT.	TRACT D	200 SQ.FT.
20	823 SQ.FT.	54	854 SQ.FT.	TRACT E	48573 SQ.FT.
21	1544 SQ.FT.	55	849 SQ.FT.	TRACT F	1807 SQ.FT.
22	1544 SQ.FT.	56	849 SQ.FT.	TRACT G	1297 SQ.FT.
23	1523 SQ.FT.	57	834 SQ.FT.	TRACT H	200 SQ.FT.
24	811 SQ.FT.	58	810 SQ.FT.	TRACT I	2498 SQ.FT.
25	2020 SQ.FT.	59	2020 SQ.FT.	TRACT J	2498 SQ.FT.
26	2020 SQ.FT.	60	2020 SQ.FT.	TRACT K	540 SQ.FT.
27	811 SQ.FT.	61	810 SQ.FT.	TRACT L	1048 SQ.FT.
28	1544 SQ.FT.	62	810 SQ.FT.	TRACT M	1747 SQ.FT.
29	1544 SQ.FT.	63	1811 SQ.FT.		
30	1544 SQ.FT.	64	1509 SQ.FT.		
31	1544 SQ.FT.	65	1509 SQ.FT.		
32	1544 SQ.FT.	66	1509 SQ.FT.		
33	1544 SQ.FT.	67	1509 SQ.FT.		
34	1544 SQ.FT.	68	1746 SQ.FT.		

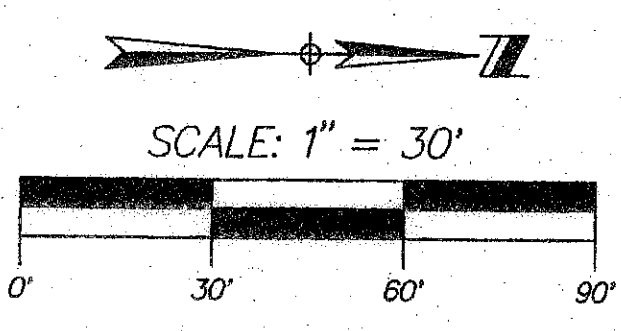
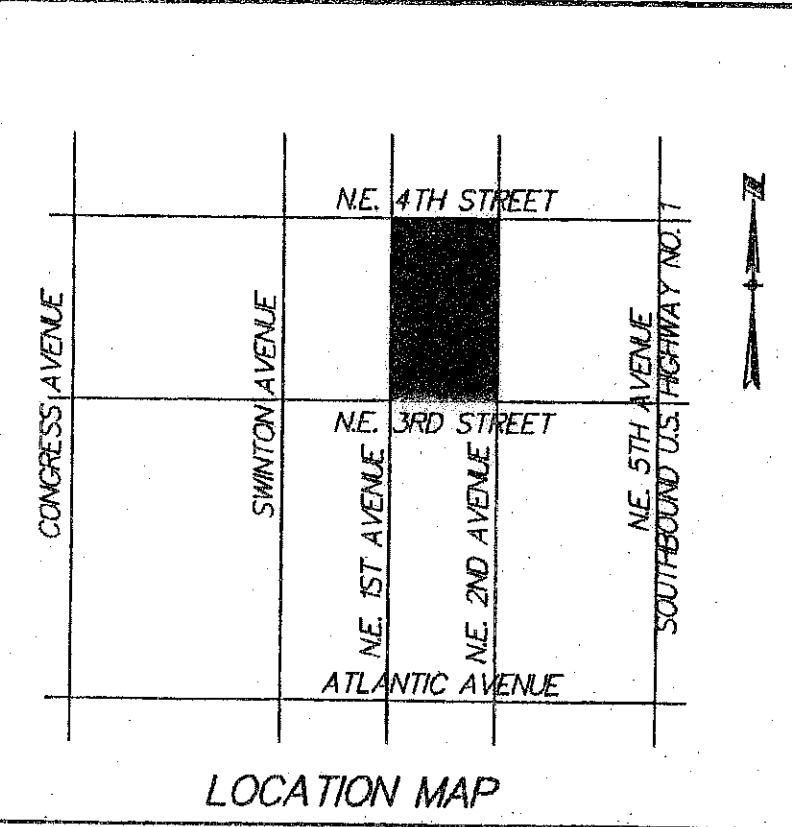

134

COUNTY OF PALM BEACH  
STATE OF FLORIDA

THIS PLAT WAS FILED FOR RECORD AT \_\_\_\_\_  
THIS \_\_\_\_\_ DAY OF \_\_\_\_\_  
20\_\_\_\_ AND DULY RECORDED IN PLAT BOOK NO. \_\_\_\_\_  
ON PAGE \_\_\_\_\_  
SHARON R. BOCK, CLERK OF CIRCUIT COURT

